

Data Sheet



Article number: 58SE100S0900G

Description: Cylinder ISO1552 SE 100x900-S-G Ø100-900
port 1/2 - with buffer adjustment

Measures

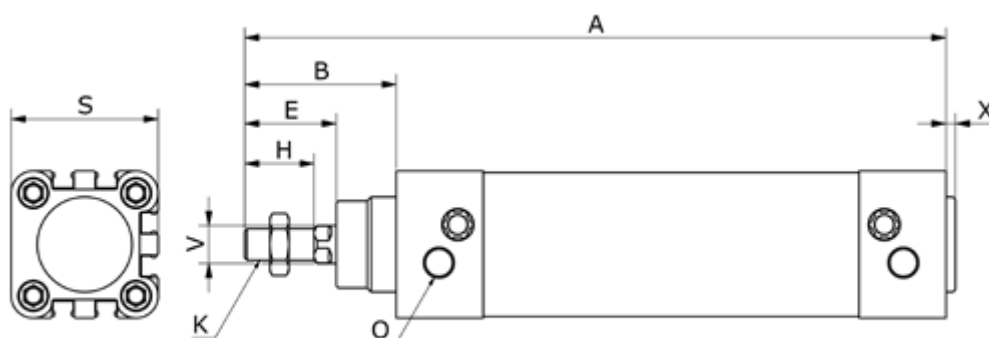

A = 1129

B = 91

Bore diameter = 100

E = 55

HS = 40

K = M20x1,50

O = 1/2"

S = 110.0

Stroke = 900

V = 25

X = 4